



Rivet Gun For Drills

OPERATION INSTRUCTIONS

Specifications:

- Drill Types - Cordless, Electric, or Pneumatic
- Drill Size - 3/8" or Larger
- Capacity - 3/32", 1/8", 5/32", or 3/16" Aluminum Standard Rivets
- Weight - .617 Lbs
- Length - 5.5"
- Diameter - 2.4"
- Minimum Cordless Requirements - 12 V or higher



INSTALLATION: Always use a reversible drill and set to drill position. Experiment with high and low speeds to achieve best results. Open the drill chuck and insert the shank of ALL18205 (FIG. 1). Tighten the chuck securely and cover with "telescopic" protective sleeve. Three nosepieces are included (use the same nosepiece for 3/32" & 1/8" diameter rivets). Use the proper size nosepiece for the rivet being installed.

ALL18205 IS NOW READY FOR USE: Insert the rivet completely; being certain the drill is in the forward position. Hold ALL18205 in your free hand to prevent spinning and actuate the drill trigger until the rivet is set and the nail has broken free. Put the drill in the reverse position and hold the trigger until the nail is released. Listen for a "click" as indication the drill is ready to accept another rivet.

MAINTENANCE: Clean and lubricate the jaws periodically, at least every 1,000 rivets. Lubricate the chuck as needed. FIG. 3 shows the breakdown of internal parts. To dismantle, remove the threaded cap (#9) where it connects to the nosepiece (#27), keep the control window "B" (FIG 2) open and turn to the left until the chuck (#17) is removed, then remove the jaws (#12).

SAFETY GUIDELINES: ALL18205 is an adapter for power reversible drills. As with any tools, proper care & maintenance must be performed to keep equipment in safe working order. The use of safety gloves & glasses is recommended. Do not wear loose fitting jewelry or garments that could get caught in this tool or drill. Be sure ALL18205 is fitted onto the drill securely to prevent any break in equipment. If the drill is powered by less than 500 watts, it may impair the capacity of the adapter as listed above.

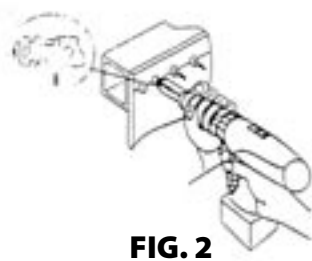

Allstar Performance 8300 Lane Dr., Watervliet, MI 49098
Phone: (269) 463-8000 Fax: (800) 772-2618 www.allstarperformance.com